

BMBF-Projekt Innorad

Projektsitzung am 25.03.2010
MTL Hamburg

Christian Vorwerk
Markus Schröppel
Manuel Weber

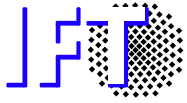

BMBF-Projekt Innorad: Standardrad

Rad 0081, 10 km/h, 25 kN

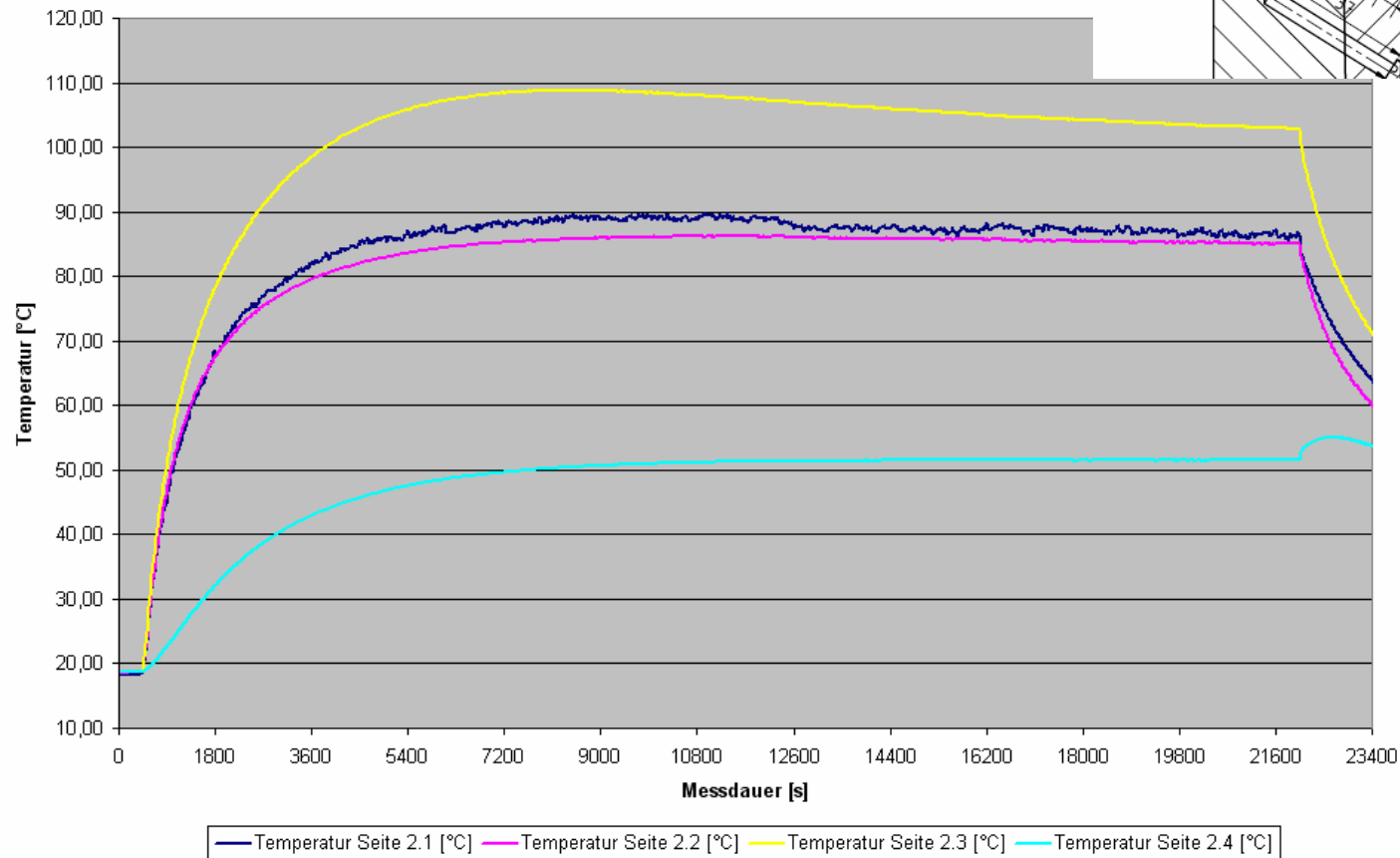
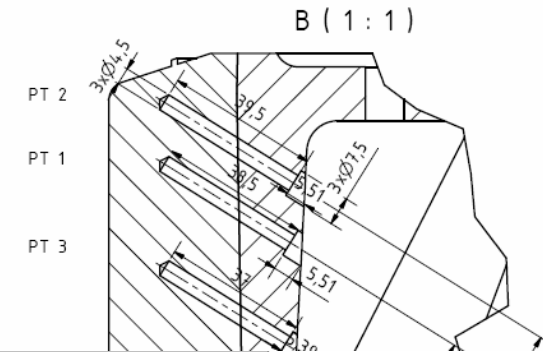

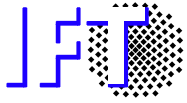

BMBF-Projekt Innorad: Variation Starttemperatur

Rad 0071, Starttemperatur: Bandage -3,0 °C , Felge 1,5 °C
10km/h, 25kN

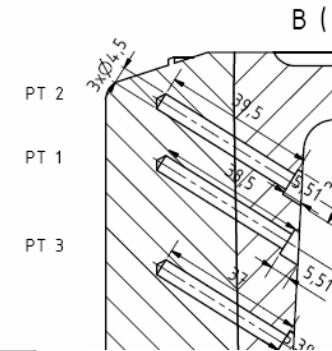
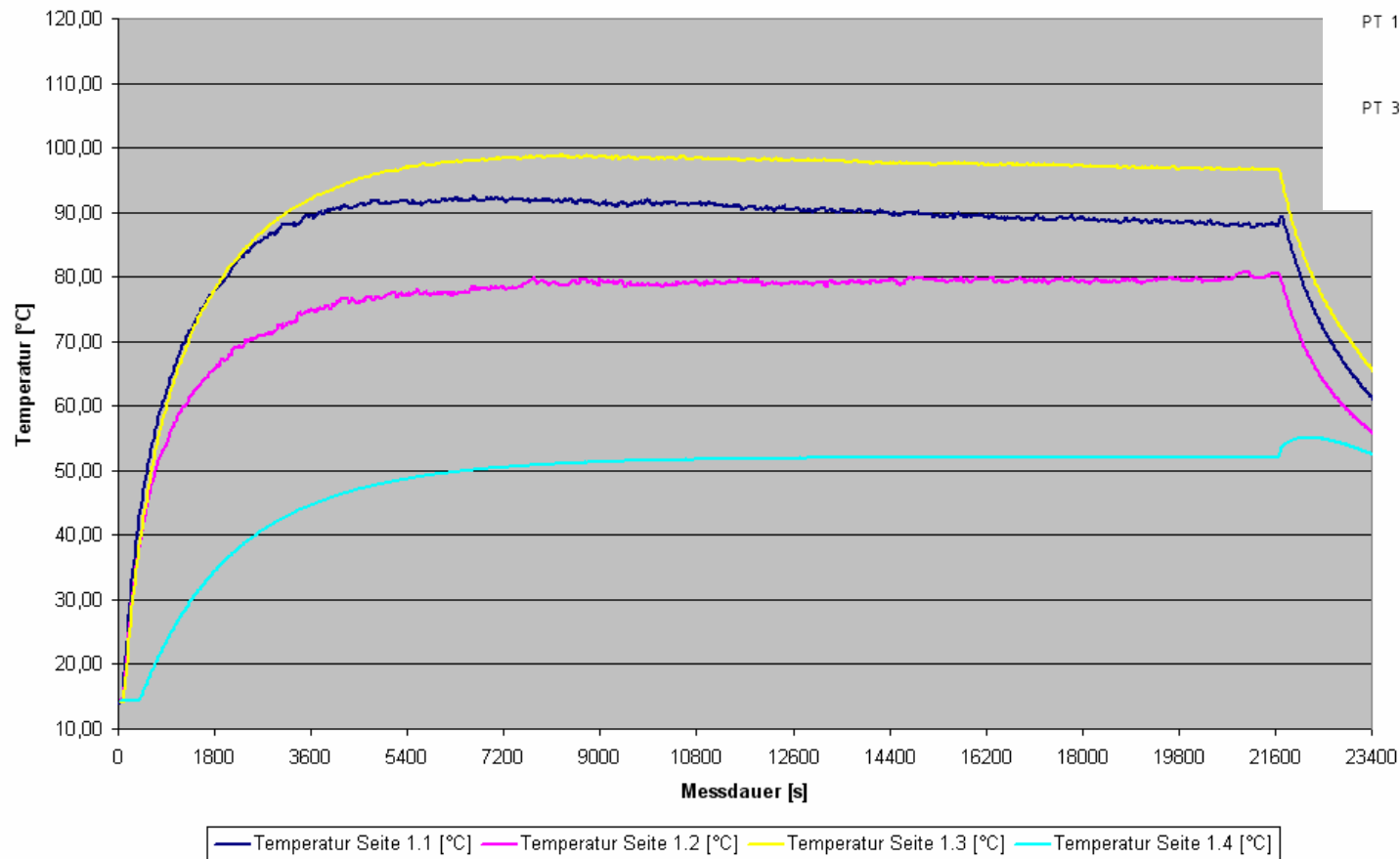

BMBF-Projekt Innorad: Variation Starttemperatur

Rad 0073, Starttemperatur: Bandage ca. 60 °C , Felge 53 °C
 10km/h, 25kN

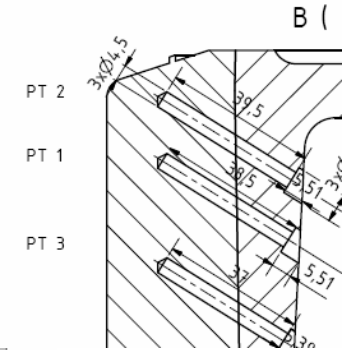
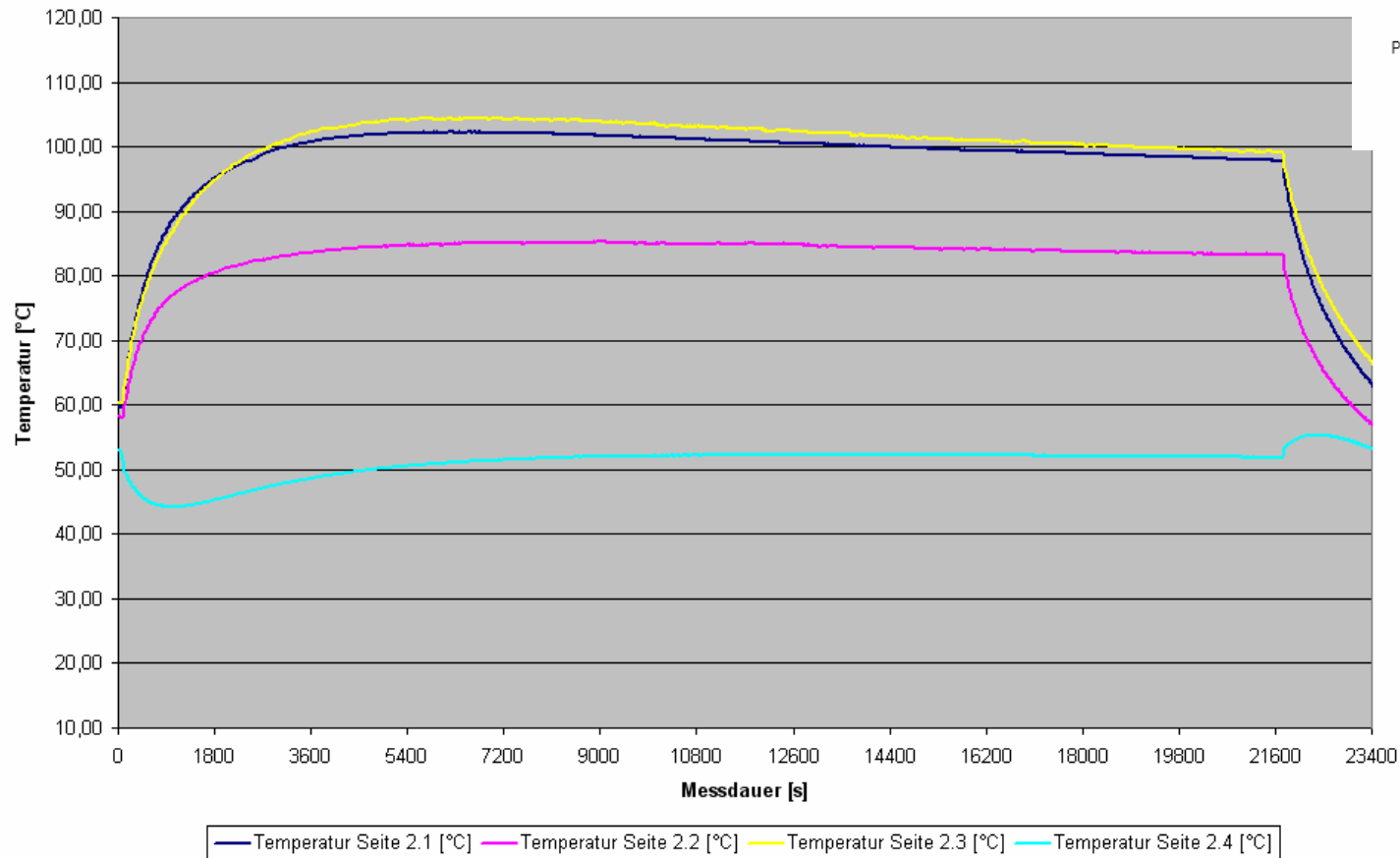

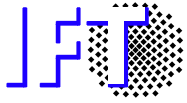

BMBF-Projekt Innorad: Variation Prüfgeschwindigkeit

Rad 0076, Prüfgeschwindigkeit: 16 km/h, Last 25kN

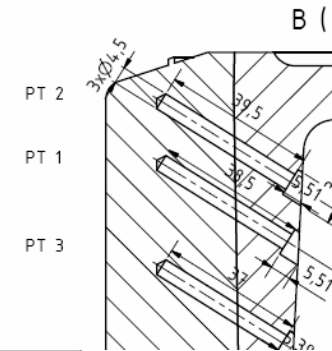
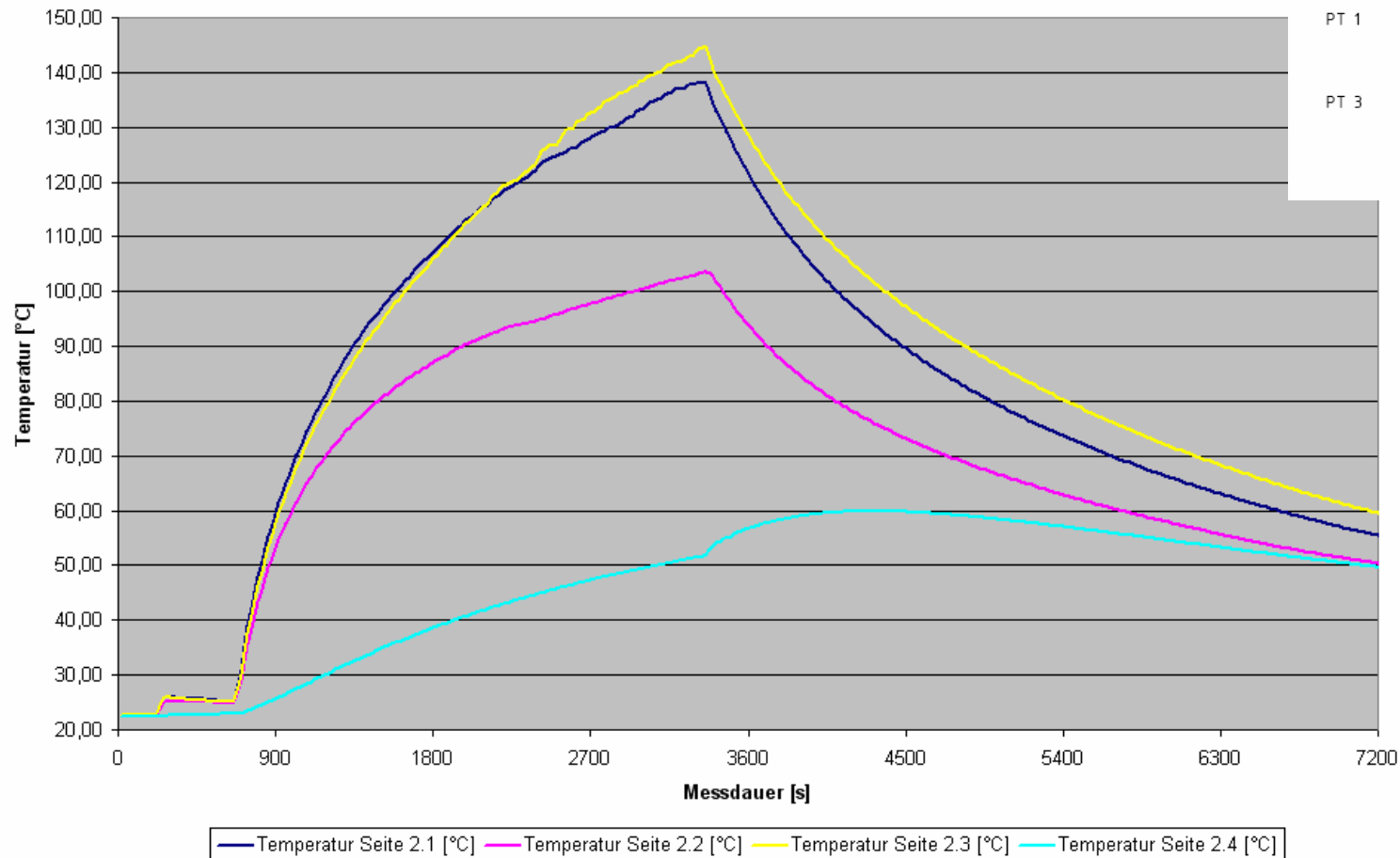

BMBF-Projekt Innorad: Variation Felgengeometrie

Rad 0046, neue Felgengeometrie

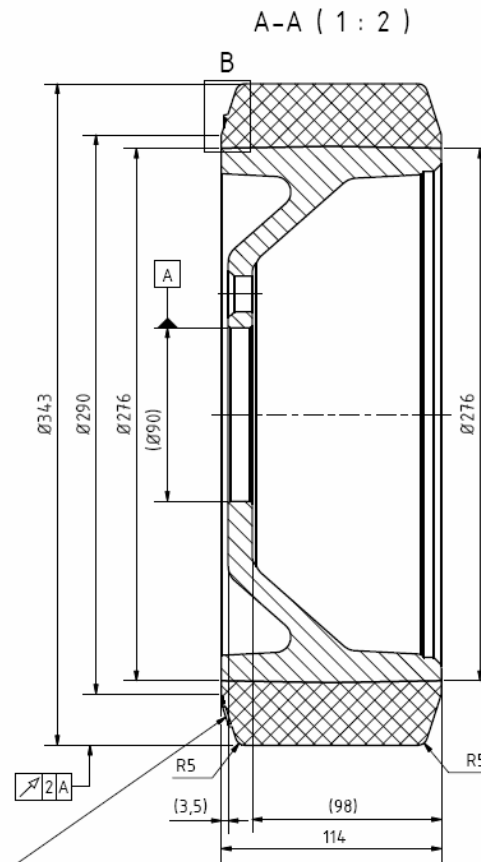

BMBF-Projekt Innorad: Variation Felgengeometrie

Rad 0046, neue Felgengeometrie, 1. Versuchsfahrt,
 10km/h, 25kN

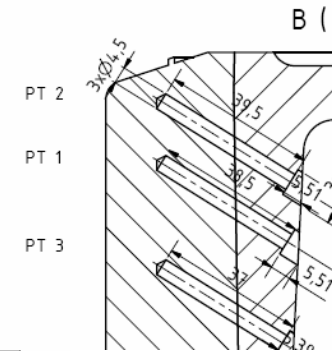
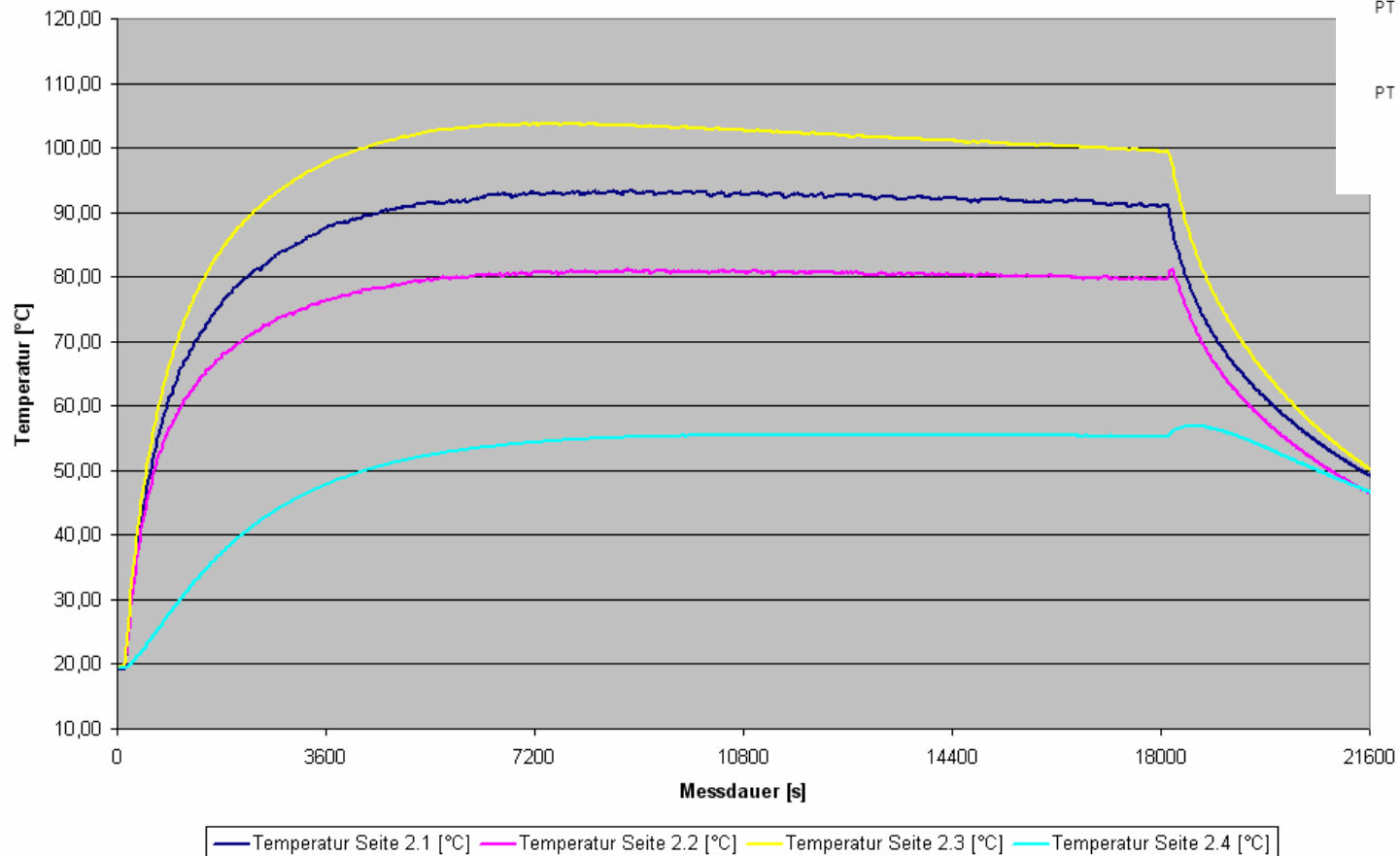

BMBF-Projekt Innorad: Variation Felgengeometrie

Rad 0046, neue Felgengeometrie, **2. Versuchsfahrt**,
 10km/h, 25kN

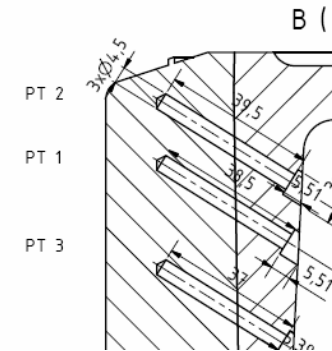
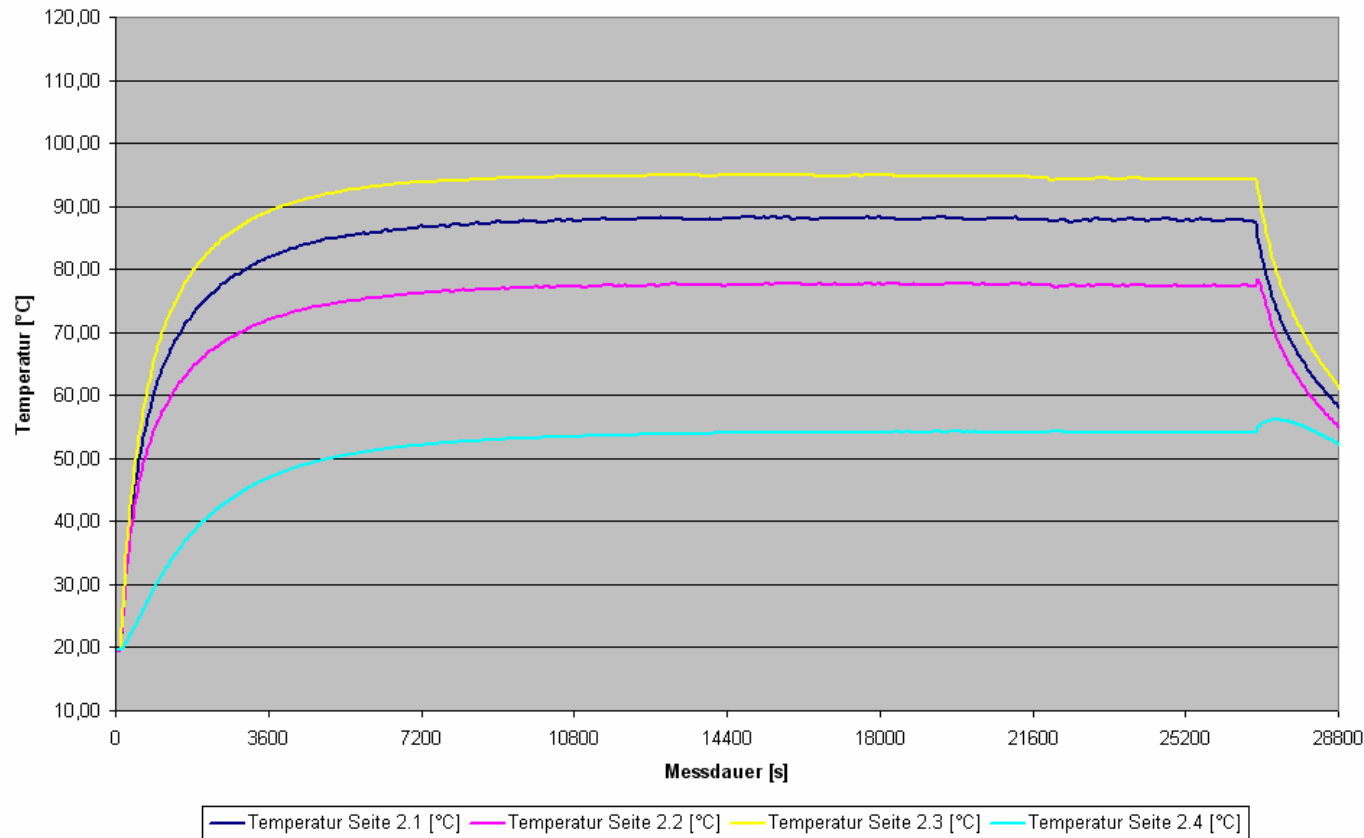

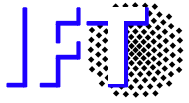

BMBF-Projekt Innorad: Variation Felgengeometrie

Einfederung Rad 0046 und Rad 0045, neue Felgengeometrie

1. Versuchsfahrt, 25kN, 10km/h

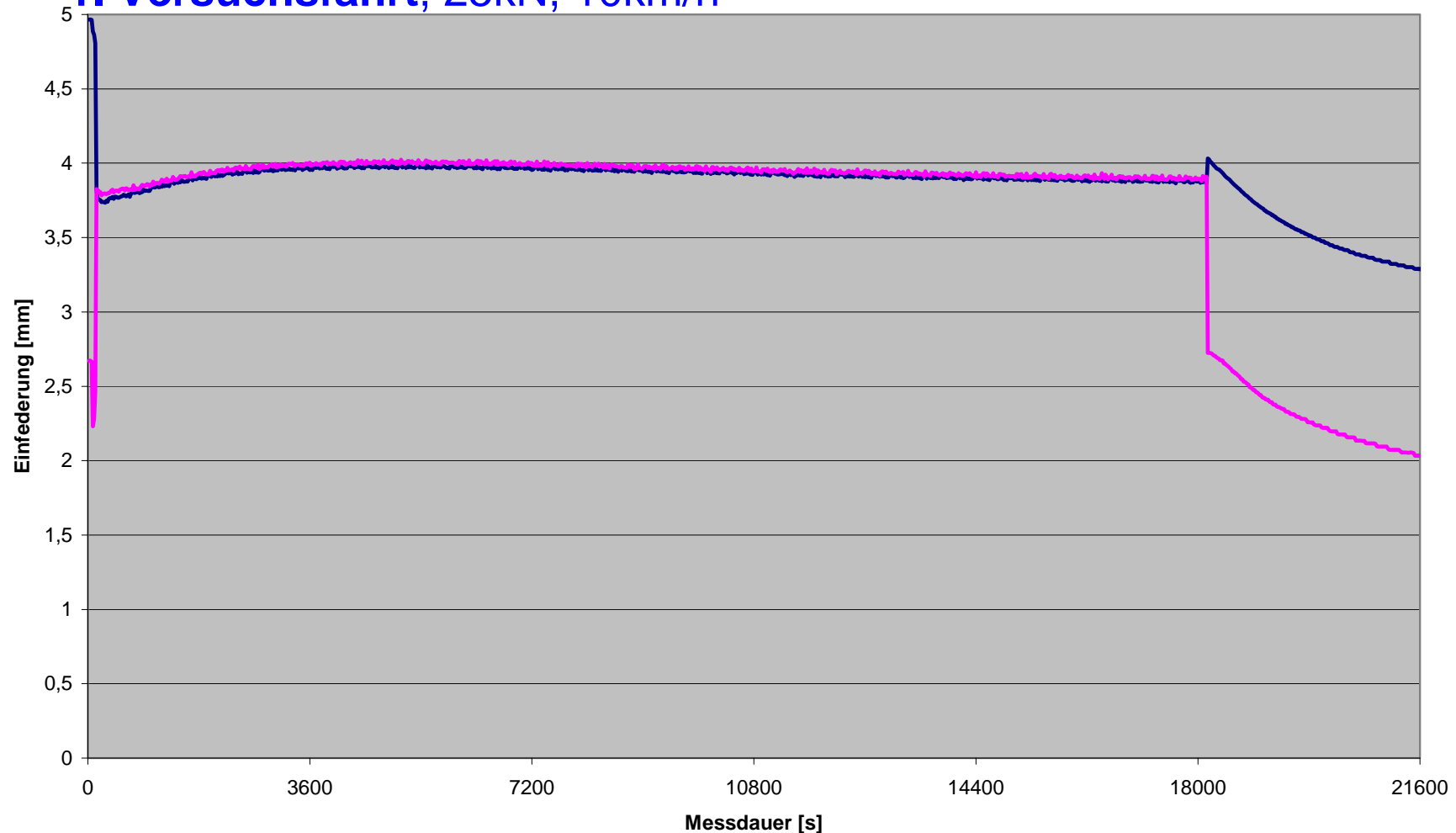

— Einfederung Seite 1 [mm] — Einfederung Seite 2 [mm]

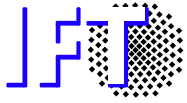

BMBF-Projekt Innorad: Variation Felgengeometrie

Einfederung Rad 0046 und Rad 0045, neue Felgengeometrie,

2. Versuchsfahrt, 25kN, 10km/h

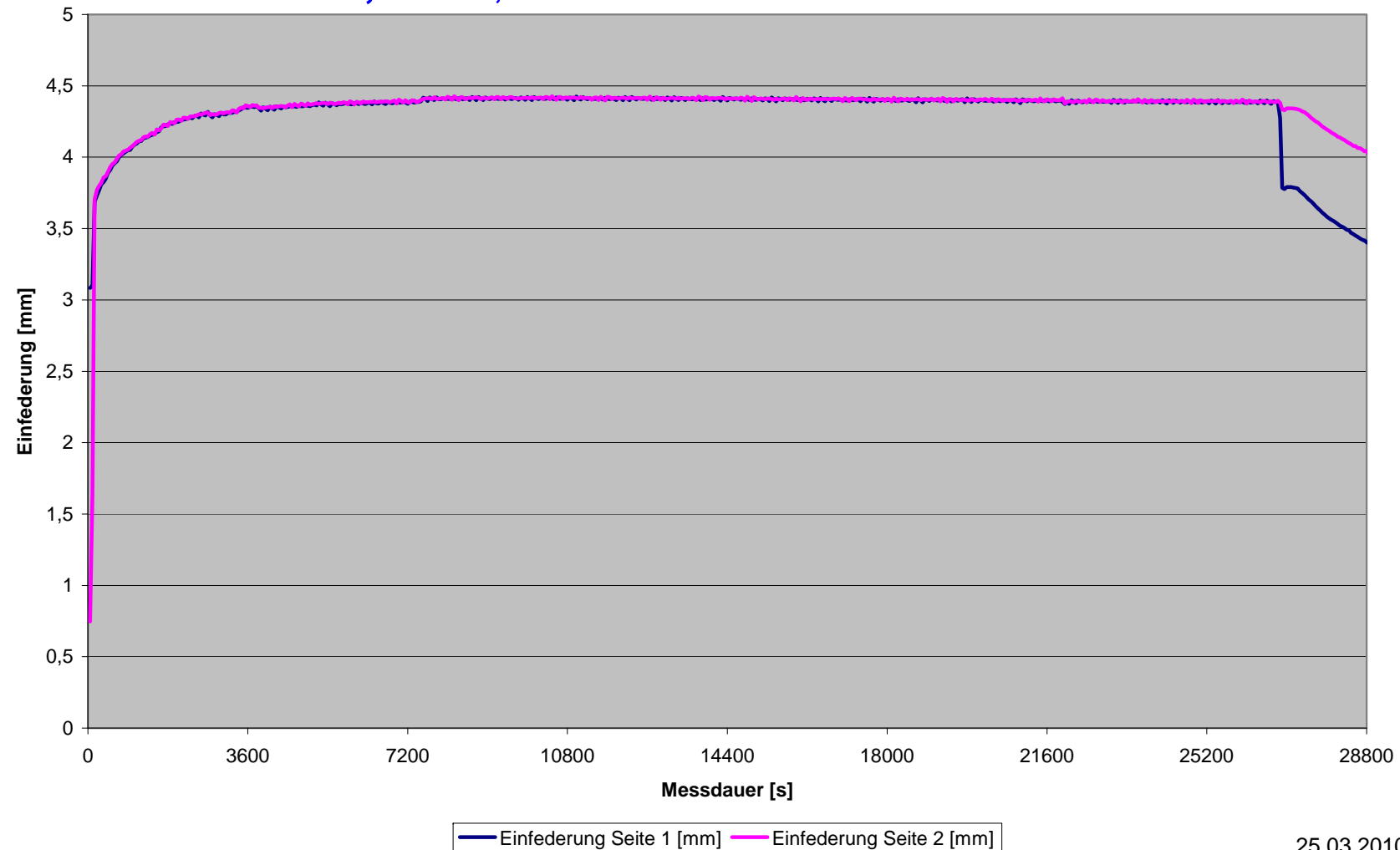

BMBF-Projekt Innorad: Prüfstand II

Testmessungen mit Versuchsträger konnten erfolgreich durchgeführt werden.

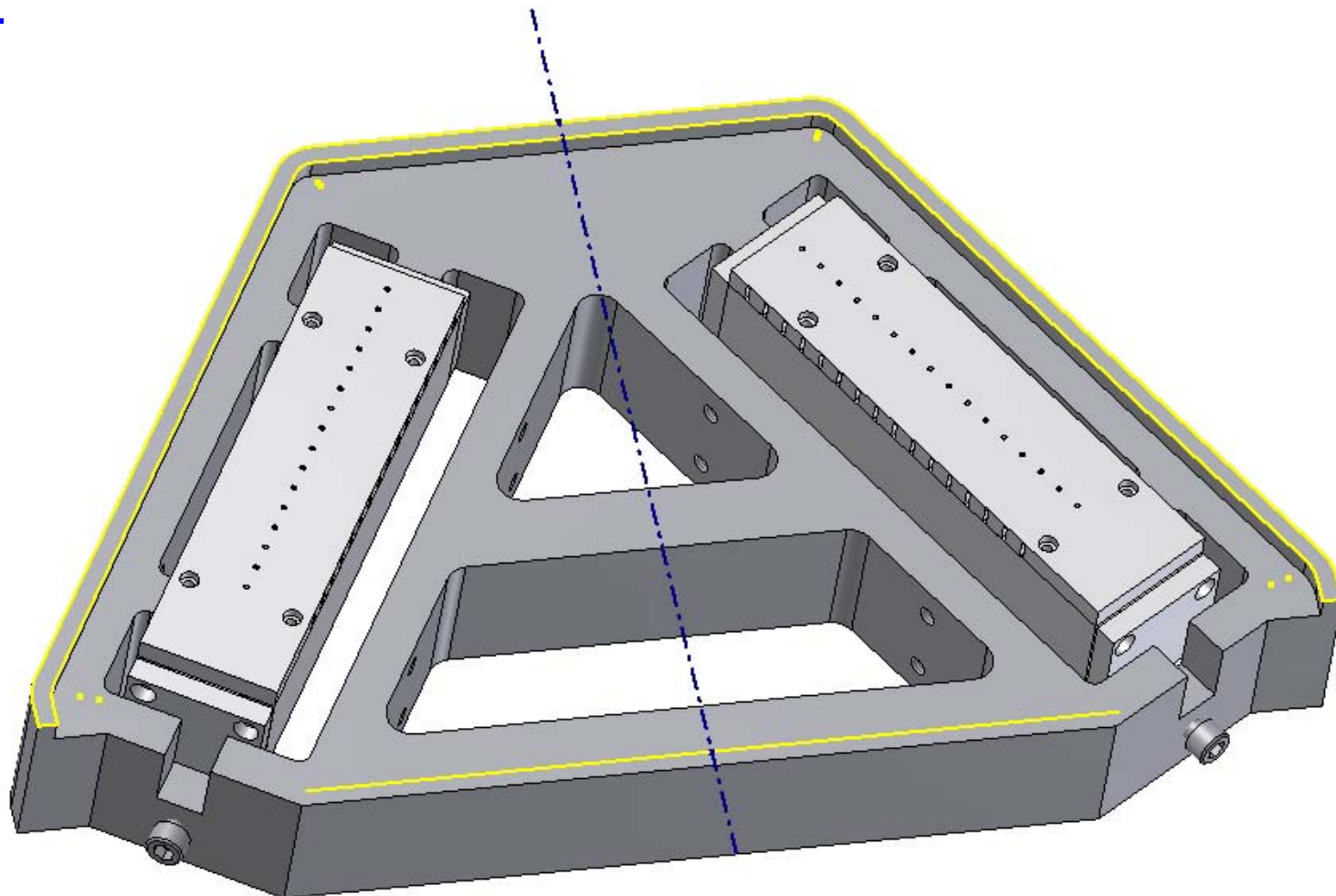

BMBF-Projekt Innorad: Prüfstand II

Testvorrichtung

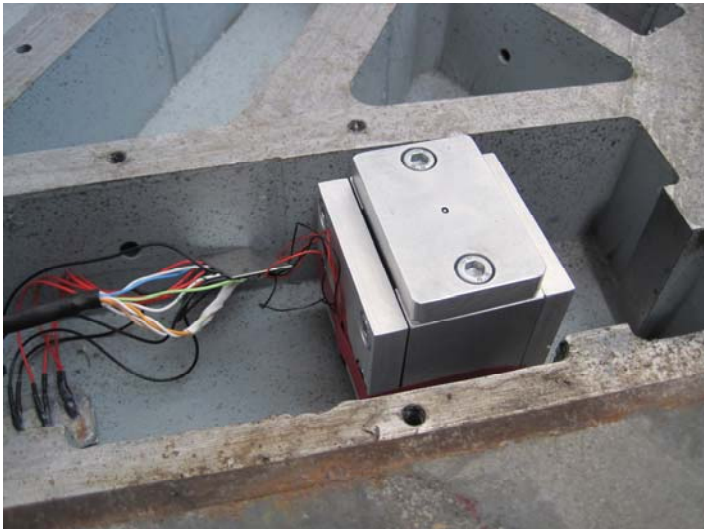
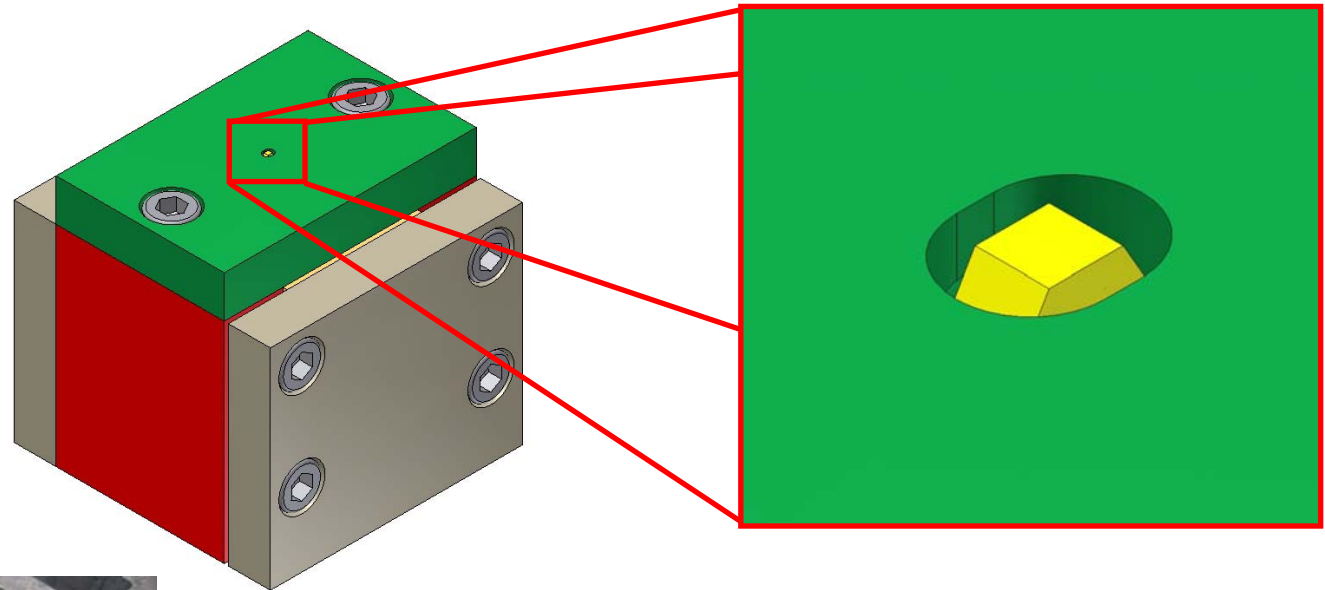

BMBF-Projekt Innorad: Prüfstand II

Variationen der Messspitzen – Kalibrierung und Testmessungen

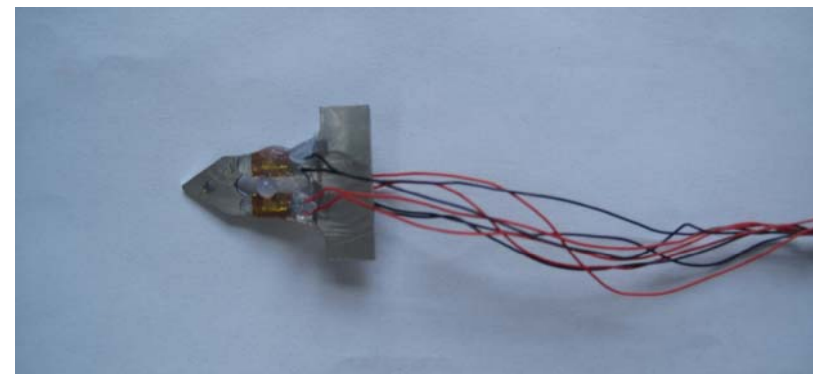
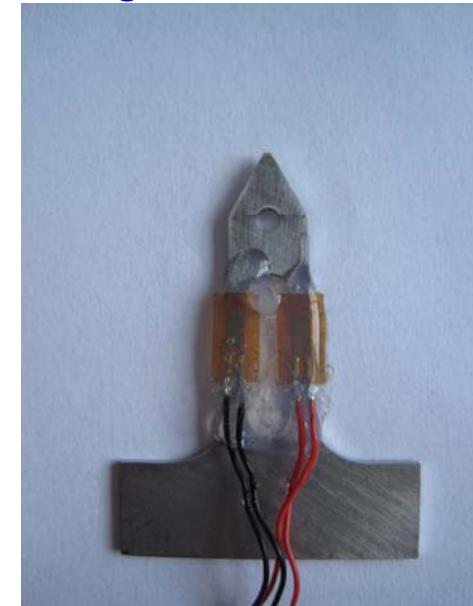
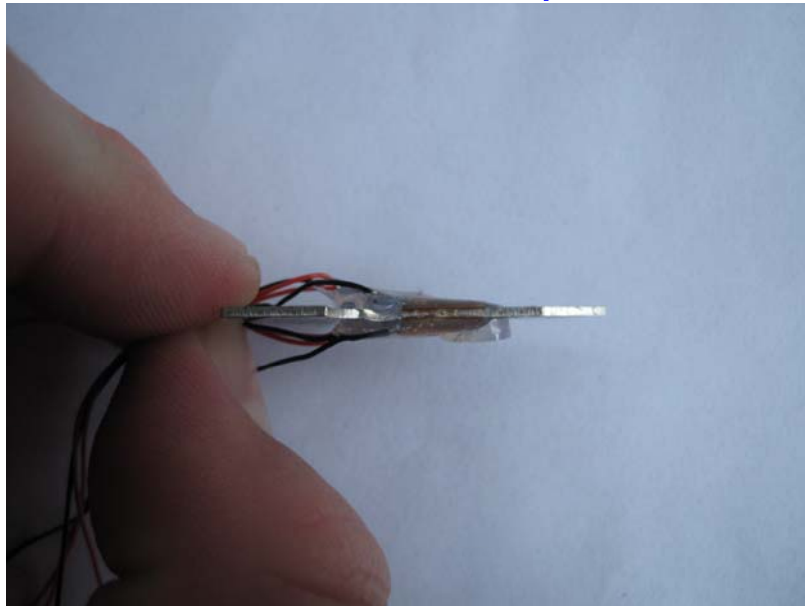

BMBF-Projekt Innorad: Prüfstand II

Integration der Testvorrichtung in den Boden des Prüfstandes

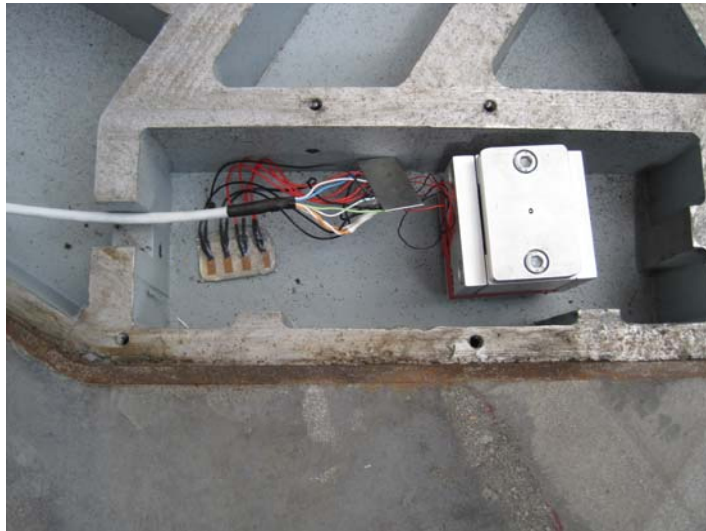

BMBF-Projekt Innorad: Prüfstand II

Überfahrt 1mm vom
 Radrand innen

1mm Kräfte

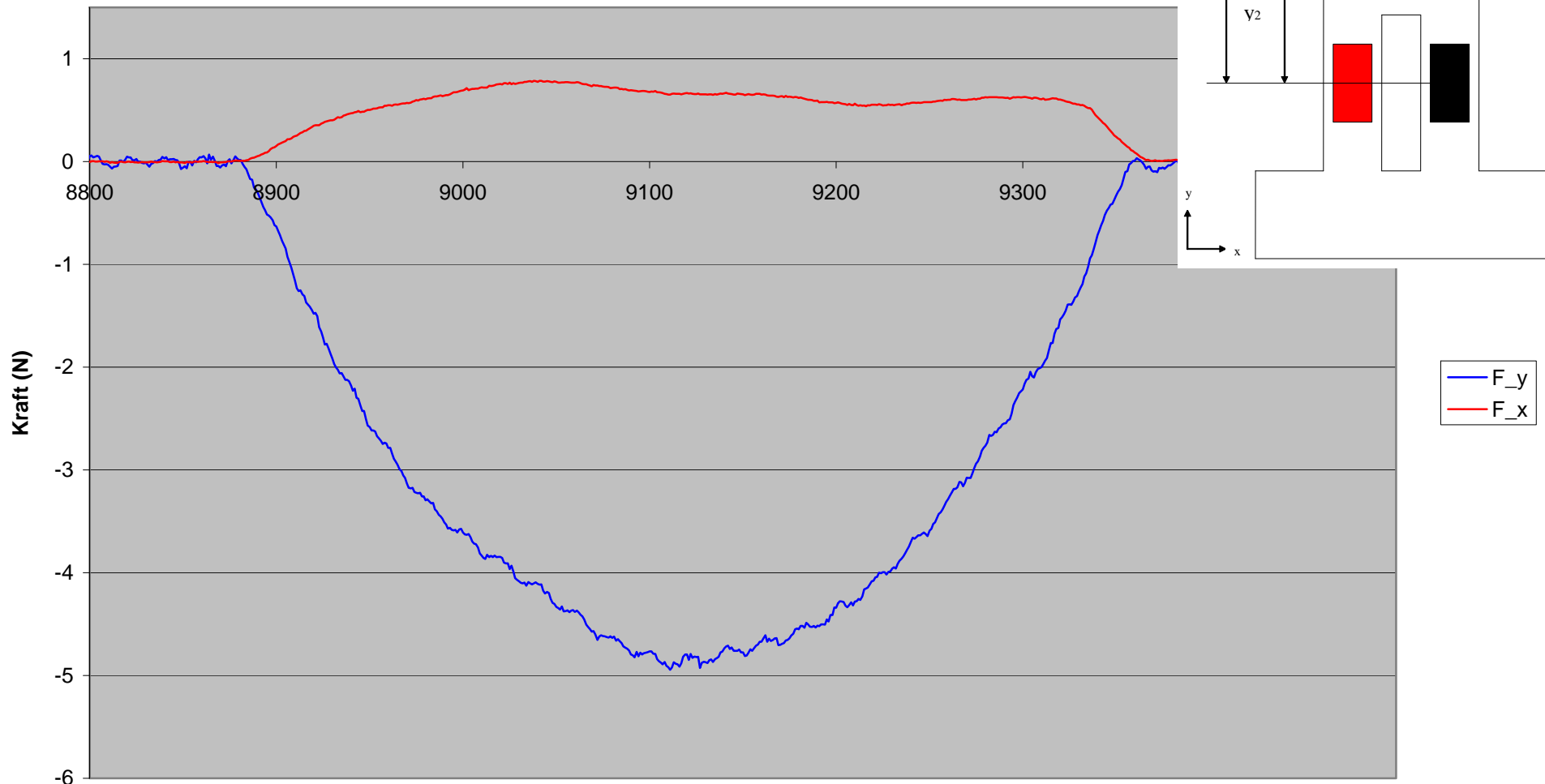

Messpunkte

BMBF-Projekt Innorad: Prüfstand II

Überfahrt 16 mm vom
 Radrand innen

16mm Kräfte

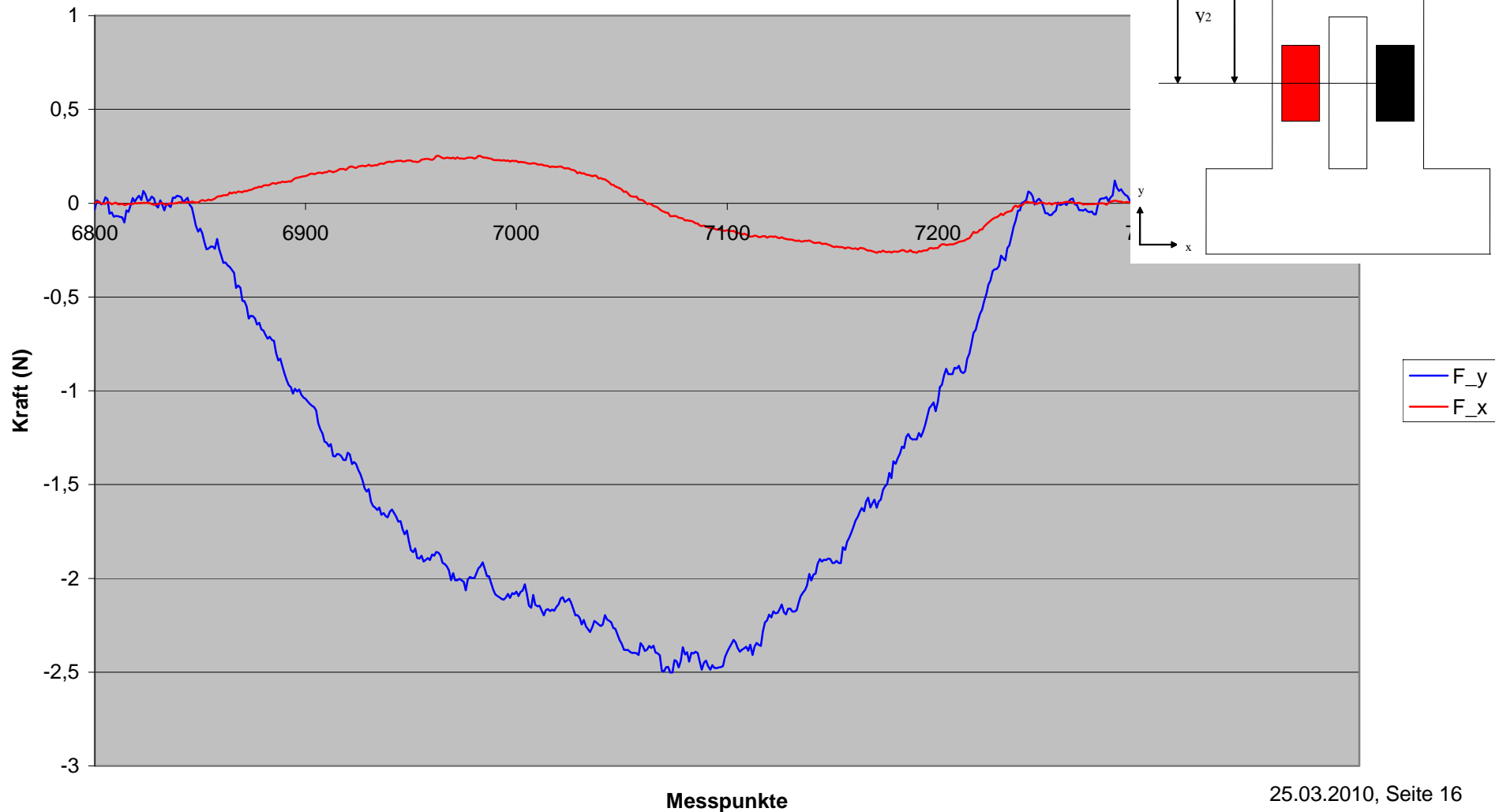

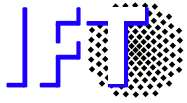

BMBF-Projekt Innorad: Prüfstand II

Verlauf Normalkräfte

Normalkraftverlauf

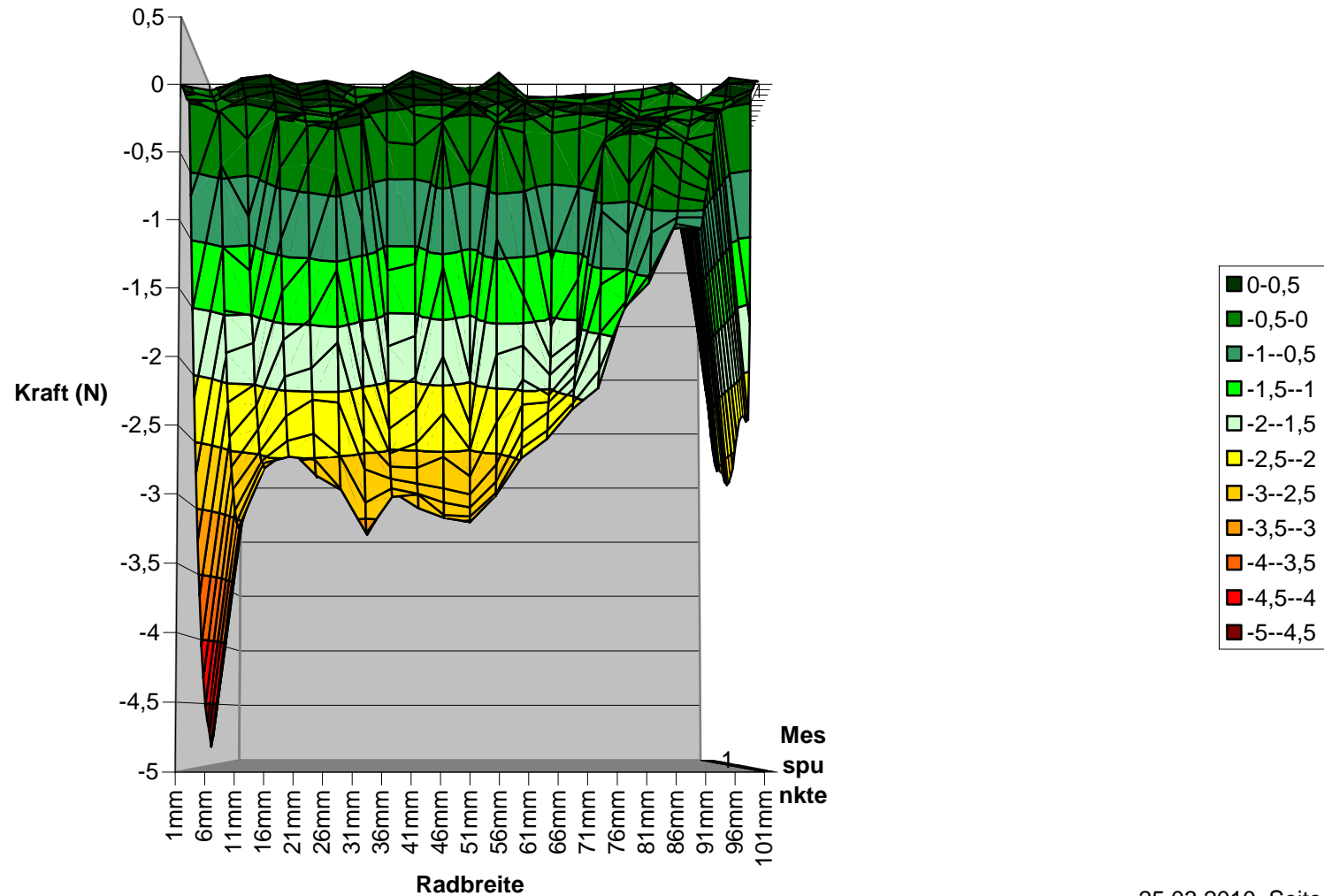

BMBF-Projekt Innorad: Prüfstand II

Verlauf Normalkräfte

Normalkraftverlauf

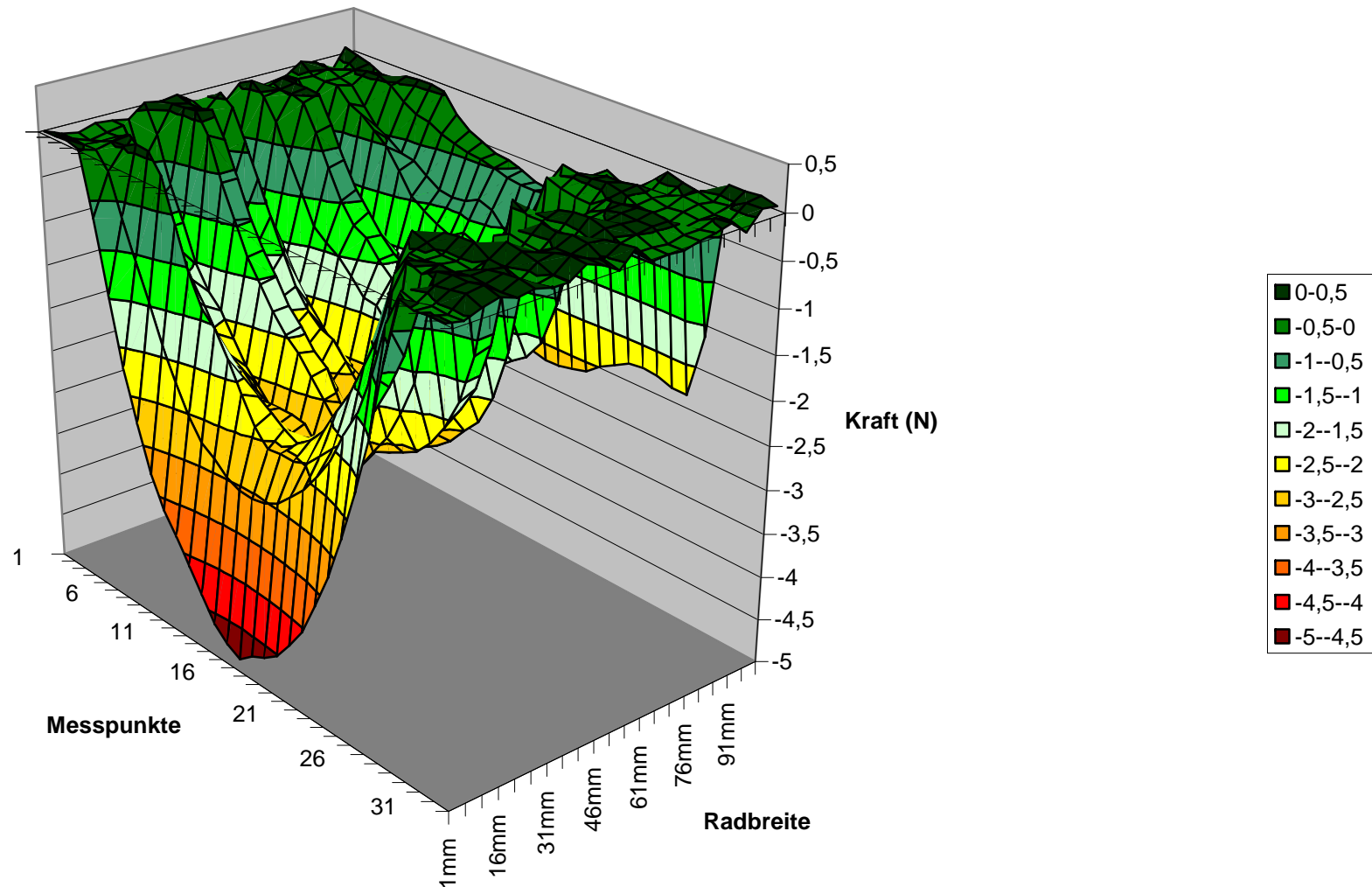

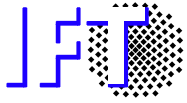

BMBF-Projekt Innorad: Prüfstand II

Verlauf Normalkräfte

Normalkraftverlauf

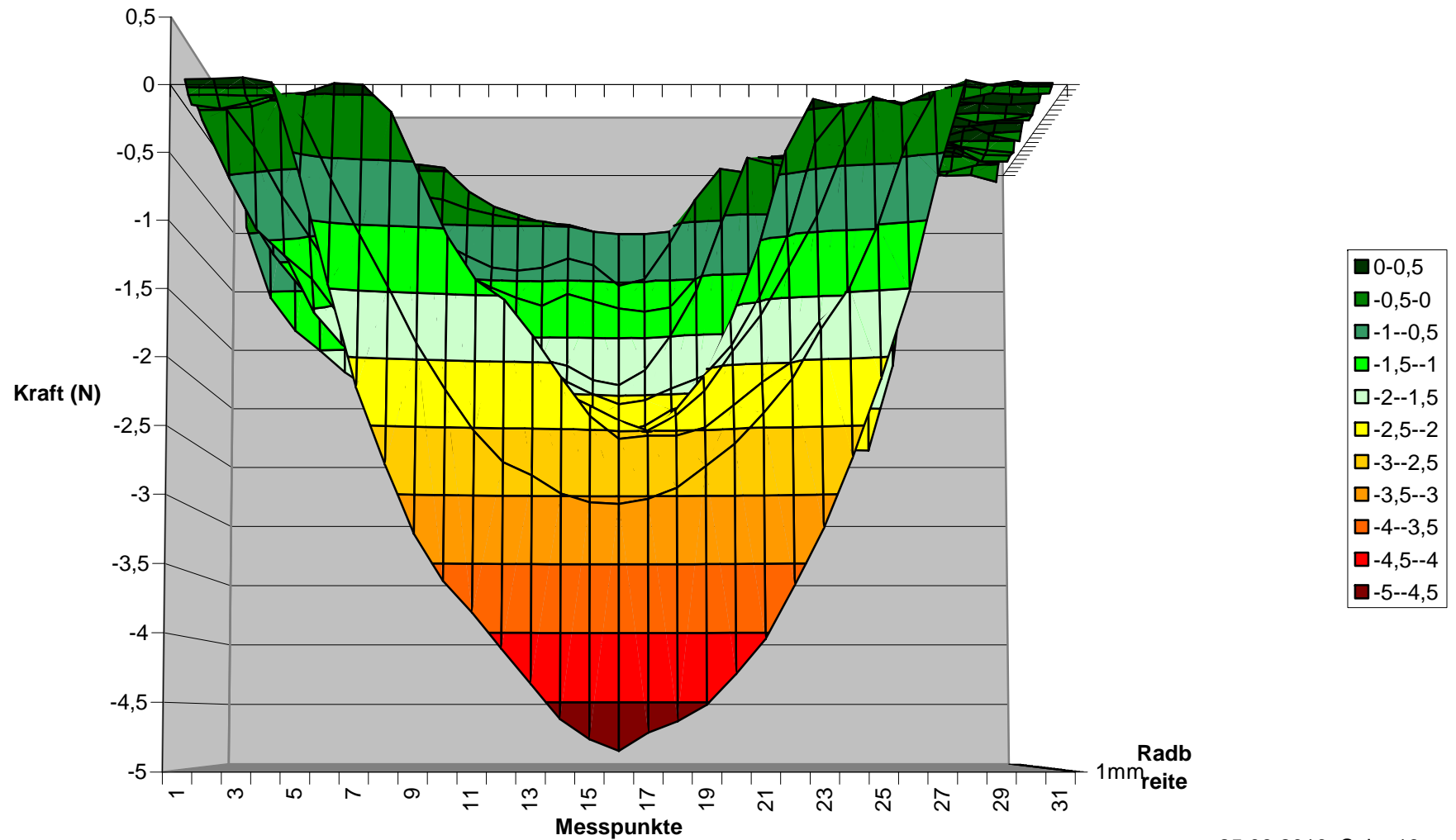

BMBF-Projekt Innorad: Prüfstand II

Verlauf Normalkräfte

Normalkraftverlauf

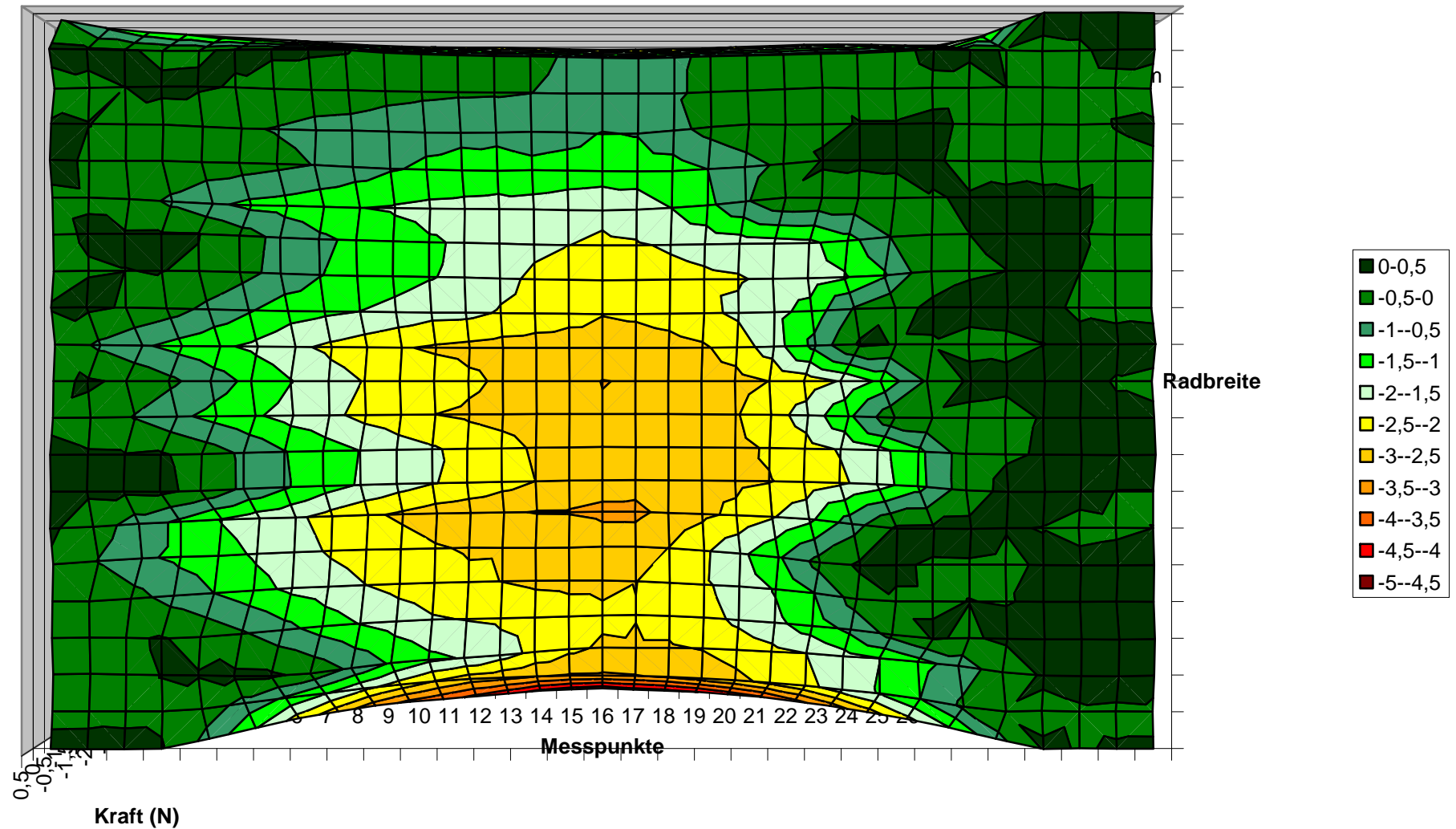

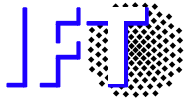

Weiteres Vorgehen...